

Optimag P

Pneumatically switched permanent magnetic lifter

Datasheet no. 306



Pneumatically switched permanent magnet supplied as a modular system in 5 standard sizes, with either fine or coarse pole magnetic configuration. Choice of pole configuration depends on the material to be held.

Fine Pole

Used for clamping or lifting thin or perforated ferrous pressings and sheet material. Double the number of magnetic poles of the coarse pole unit; the magnetic circuit is completed by far thinner material. This is why the fine pole Optimag P can pick up single sheets from the top of a stack without attracting the sheet below.

Coarse Pole

Used for clamping or lifting of materials with rough, uneven surfaces. The coarse pole Optimag P also provides greater clamping forces on thicker materials than the fine pole unit.

Fail Safe

The cylinder houses a high performance neodymium magnet pack. This is moved to contact the work piece when the magnet is switched on. If the air fails, the magnet pack stays in position, the Optimag P stays energised and the load stays held. The Optimag P does not become de-energised until an air supply is used to switch it off.

Typical Uses

- Robotics
- Pick and place
- Transfer machinery
- End of arm grippers for manipulators
- Jigs and fixtures
- General lifting
- Turnover applications

Benefits

- Fail-safe operation
- Ideal for thin or uneven surfaces
- Can hold through large air gaps such as packaging
- No damage to parts being handled
- One module suits many applications
- Simple to extend existing systems
- Multiple parts can be picked in a single operation
- Initial part positioning not critical
- Excellent weight to performance ratio
- Low maintenance
- Single point fixing

Technical Data

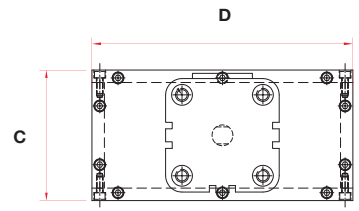
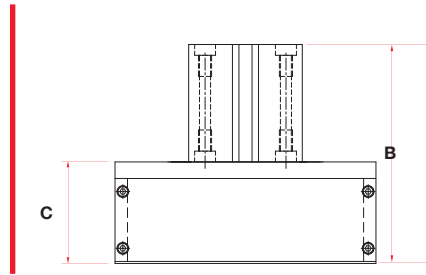
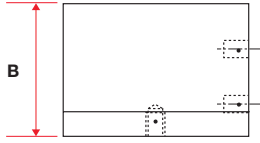
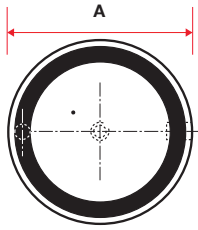

Circular

Rectangular

Central mounting hole: M10 x 0.8
Anti-rotation hole - 0.24" diameter

Product Information

Product	Load Profile	Self Working load lbs	Dimensions inches				Unit Weight
	inches		A	B	C	D	ilbs
Circular							
Optimag 100P	Flat	41	4	3.4	N/A	N/A	7
Optimag 125P	Flat	64	5	3.7	N/A	N/A	13
Optimag 150P	Flat	130	6	4.4	N/A	N/A	19.4
Rectangular							
Optimag 1020P	Flat	165	N/A	6.7	4	8	13.2
Optimag 2030P	Flat	220	N/A	7.2	12	12	26.4

For lifting applications a SWL of 3:1 is recommended

Specification

Air requirements	Only required during switching
Air pressure	21.75 psi minimum – 29 psi maximum
Air connection	1/8" BSP
Temperature	Maximum 122°F

Materials

Outer shell material	Aluminium blue anodised finish
Front working face	Stainless steel with rubber protection ring
Magnet material	Rare earth neodymium iron boron

If you have any more questions, require technical assistance or would like a quotation, please contact us.

www.eclipsetoolsinc.com

Eclipse Tools North America Inc.

442 Millen Road, Unit #9, Stoney Creek, Ontario, L8E 6H2, Canada

T 1-800-260-2124 F 1-800-260-1410

sales@eclipsetoolsinc.com www.eclipsetoolsinc.com

While every effort has been made to ensure the accuracy of the information in this publication please note that specifications may change without notice.



FM31278