





Liquid Filter

At A Glance

-  **Protection: Secondary**
-  **Feed Type: Pumped / Liquid Line**
-  **Material Type: NdFeB**
-  **Cleaning Type: Manual**

Our high intensity liquid filter magnetic separator has been designed to operate in pressurised transfer lines to provide protection against ferrous and para-magnetic contamination.

The housing comprises a vessel, magnetic lid assembly and swing bolts, which secure the unit together. The filter is available in two versions, single wall and double wall (jacketed for heated pipelines).

The filter can be used in any line that processes liquids at all viscosity levels and can be installed at any angle from vertical to horizontal. A common installation location is tanker loading and discharge to inspect outgoing and incoming materials. The filter can be supplied to suit various processing volumes, pressures, temperatures and specifications.



Benefits

- Easy to clean
- Meets audit requirements
- No consumables
- Removes sub-micron sized contaminants
- Suitable for use in ATEX environments (out of scope certificate available)

Performance

Magnetic Performance	Magnetic Performance 10,000 (Easy Clean), 12,000 (Fixed) Gauss & 8,000 SmCo
Performance Reading	Product Contact Surface
Magnet Grade	NdFeB or SmCo grade dependent on performance required
Working Temperature	-20°C / +80°C (+225°C for SmCo units)
Working Pressure	+ 10 Bar

Suitability

Suitable Products	Chocolate, molasses, jam, syrup, juice, sauce, pastes, soup, pickles, spreads, beverages etc.
Suitable Location	All, vertical, horizontal or angled
Clearance	Minimum 1.5 to 2x height of unit required to remove magnets

Materials

Magnetic Material	Rare Earth Neodymium Iron Boron - (NdFeB or SmCo)
Housing	316 grade stainless steel
Tubing	316L grade stainless steel
Other Parts	304 grade stainless steel
Sealing	Silicon rubber O-ring
Drain	1" BSP drain plug
Surface Finish	Brushed 0.8µm Ra Internally, 1.2µm Ra Externally

Cleaning

To clean, simply release the quick release swing bolts, remove the contaminated cartridge from the housing. For Easy Clean units, remove the magnet cores from the tube and wipe the tubes with a clean cloth to remove contamination. Attracted contamination can then be sent for further analysis.

Options

- Pharmaceutical specification
- Hygienic fittings
- Higher temperature versions available, up to 225°C
- Higher pressure versions available, up to 30 bar
- EPDM, viton or metal detectable seal options also available
- Flange options: PN16, PN10, plain spout, ANSI B150, SMS, RJT, DIN11851, Tri Clamp, other options available
- Other sizes available (Metric, Imperial and Sched)

Liquid Filter

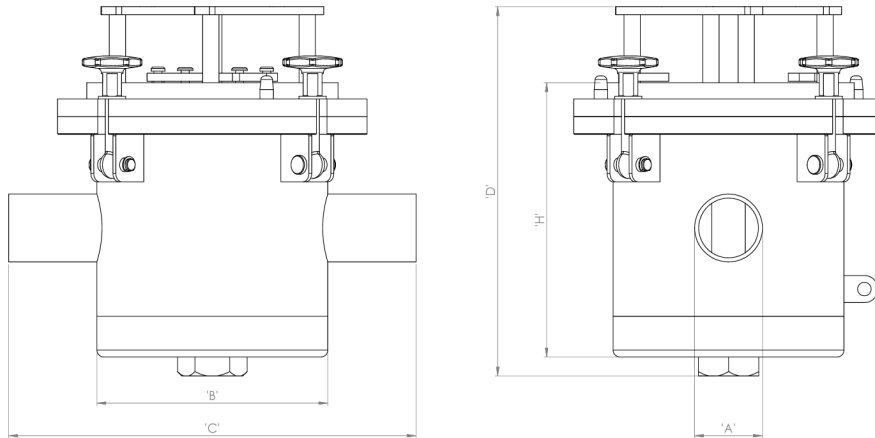

Part Number (Single Wall)	Spout Dia. A (mm)*							Dia. B (mm)	C (mm)	D (mm)	H (mm)	Number Of Rods	Weight (kg)
	38.1	50	75	100	125	150	175						
ILF110	✓	✓						116	250	233	163	3	11
ILF140	✓	✓	✓					146	300	262	192	5	17
ILF200		✓	✓	✓				170	350	272	202	7	22
ILF300		✓	✓	✓	✓	✓	✓	260	450	370	300	9	36

*Imperial Pipe Sizes/Sched Pipe also available on request

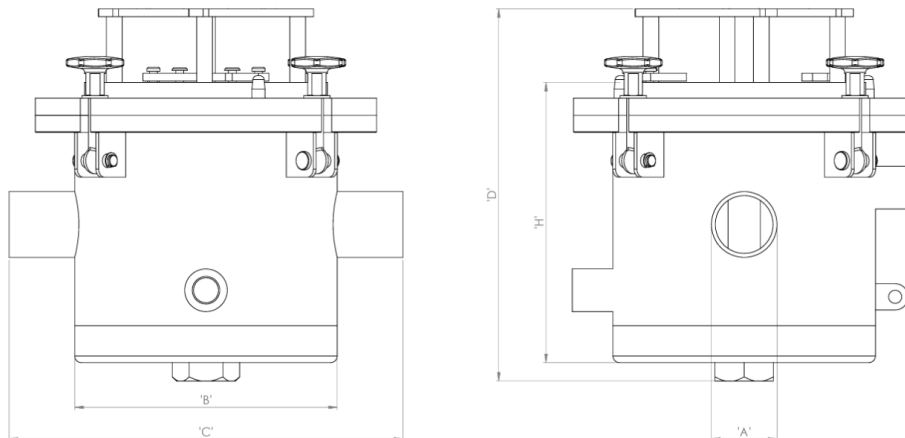

Jacket Port: 3/4" BSP Socket

Part Number (Jacketed)	Spout Dia. A (mm)*							Dia. B (mm)	C (mm)	D (mm)	H (mm)	Number Of Rods	Weight (kg)
	38.1	50	75	100	125	150	175						
ILF110/J	✓	✓						146	250	243	173	3	11
ILF140/J	✓	✓	✓					176	330	272	202	5	17
ILF200/J		✓	✓	✓				200	380	283	213	7	22
ILF300/J		✓	✓	✓	✓	✓	✓	300	490	381	311	9	36

*Imperial Pipe Sizes/Sched Pipe also available on request

For non-standard sizes, please contact sales@eclipsemagnetics.com